

THEATRE TECHNICAL SPECIFICATIONS

<p>The Yukon Arts Centre Theatre opened in 1992, located next to Yukon College in Whitehorse, Yukon. It is a wheelchair-accessible, climate-controlled Class "A" facility featuring a Public Art Gallery, rehearsal hall, and shop.</p>	
<p>THEATRE</p>	
Seating:	Main Floor: 306. Balcony: 112. Wheelchairs: 10 Total: 428 (10 seats are always reserved for the volunteer ushers)
Stage description:	Elevated proscenium with removable apron, orchestra pit and fly loft. No traps unless custom fitted within apron sections.
Stage Floor:	Black 1/4" marmoleum on 1/8" cork on 3/4" plywood NOTHING MAY BE SCREWED OR FASTENED TO THE STAGE FLOOR
Stage Width:	47' / 14.33m
Stage Depth:	37' / 11.28m
Proscenium opening:	Width: 48' / 14.63m / Height: 24.5' / 7.47m
Clear height to P.A. cluster:	22' / 6.71m
Plaster line to US	32' / 9.75m
Plaster line to DS apron edge:	32' / 9.75m
Centre line to SR fly rail:	41.5' / 12.65m
Centre line to SL wall:	46' / 14.02 m
<p>DRESSING ROOMS and GREEN ROOM and STUDIO</p>	
<p>#1 & #2: 7' X 7' w/ shower, washroom, sink, prep and dressing area. Dressing Room #1 is fully wheelchair accessible.</p>	
<p>#3 & #4: 10' X 23' w/ showers, washrooms, sinks, prep and dressing tables.</p>	
<p>Green Room: 21' X 23' w/ fridge, range, microwave, sink, telephone, piano.</p>	
<p>Studio Theatre: 39'6" x 25'6" w/ full length mirror along Northern wall, sprung floor.</p>	

FLY INFORMATION – Operated from SR Stage Level and SR Catwalk (26')	
Total Line-sets:	36
Line-sets Occupied:	Please Request Current List
Loading Capacity:	1700lbs / 771 kg
Length of Pipes:	60ft. / 18.29m
Diameter of Pipes:	1.5" / 3.81cm. Schedule 40
Grid height:	62.5' / 19.05m
STAGE DRAPERY	
1 Main Valance (Navy Blue): Line-set 1	
1 Main Curtain (Navy Blue) drawn or flown: Line-set 2	
6 sets of Black Legs 28' X 10' / 8.53 m x 3.04 m (Flown)	
4 sets of Black Legs 32' X 10' / 9.7 m x 3.04 m (Stored)	
4 sets of Black Borders 9'9" x 60' / 2.74 m x 18.29 m	
1 Black Scrim 28' x 60' / 8.53 m x 18.29 m	
1 White Scrim 28' x 60' / 8.53 m x 18.29 m	
2 traveller tracks with blacks, 1.5 fullness, split at Centre: Line-sets 24 and 39. [Operated SR]	
1 white 28' X 60' / 8.53 m X 18.29 m cyclorama	
2 white 30' X 60' / 9.14 m X 18.29 m cycloramas	

STAGE PLANS: PLEASE CONTACT THE TECHNICAL DIRECTOR

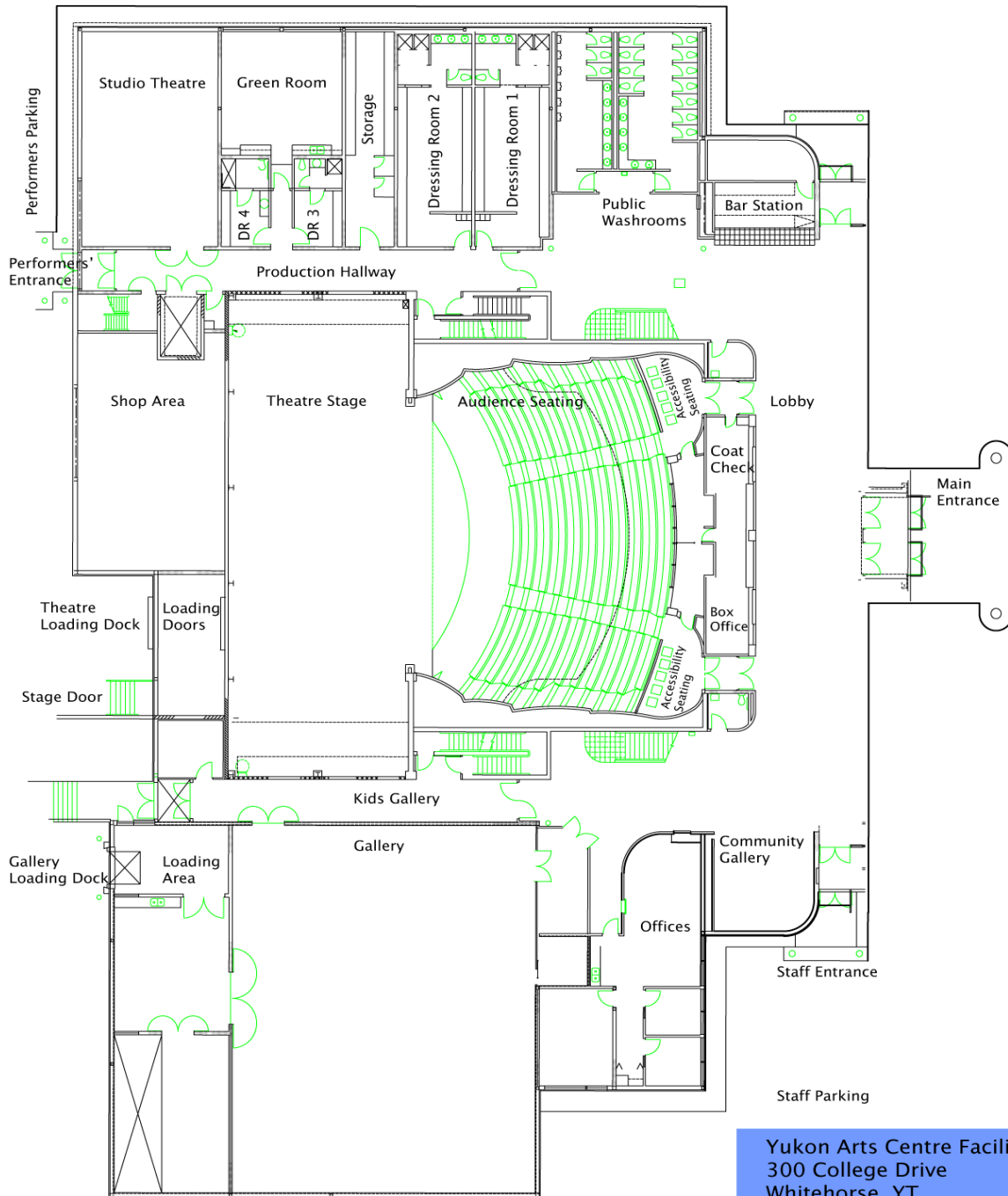

Yukon Arts Centre Facility
300 College Drive
Whitehorse, YT
www.yukonartscentre.ca
Image is not to scale

THEATRE AUDIO INVENTORY

Audio Inventory Front of House	
FOH Console	SOUNDCRAFT VI6 Digital Mixer
	64 mono balanced inputs into 35 outputs
	Mono inputs linked to create stereo inputs
Busses:	32 Grp/Aux/Matrix plus Main LCR Mix and LR Solo Bus
Stage Box:	64 XLR inputs and 32 XLR outputs
Front of House Speakers, JBL System	
Fill Speakers	6 JBL AC18/95
Centre	1 JBL AM5212/26
Main Speakers	4 JBL AM7212/95
	2 JBL ASB6128
Reverb Enhancement Speakers	12 JBL AC16
Surround Speakers	
	14 JBL Control HST-WH
	2 JBL CONTROL 28T-60-WH
	4 JBL AC16
Monitor Mixer/Alternative Front of House Mixer	
Monitor Console	SOUNDCRAFT VI1 Digital Mixer
	32 Mono Balanced Inputs
	2 Stereo inputs
	L,R and M outputs
	24 Auxiliaries
Monitor Mode	Can provide up to 16 mixes
Monitor Speakers	16 JBL STX812M (800w 12" Two-way)
800w 12" Two-way	4 JBL STX818S (1000w 18" Subwoofer)
Playback and Recording	
	Q-lab on Mac Mini
	Sound Devices Multi-track Recording
Wireless Microphones/Wireless Receivers/Microphone Transmitter	

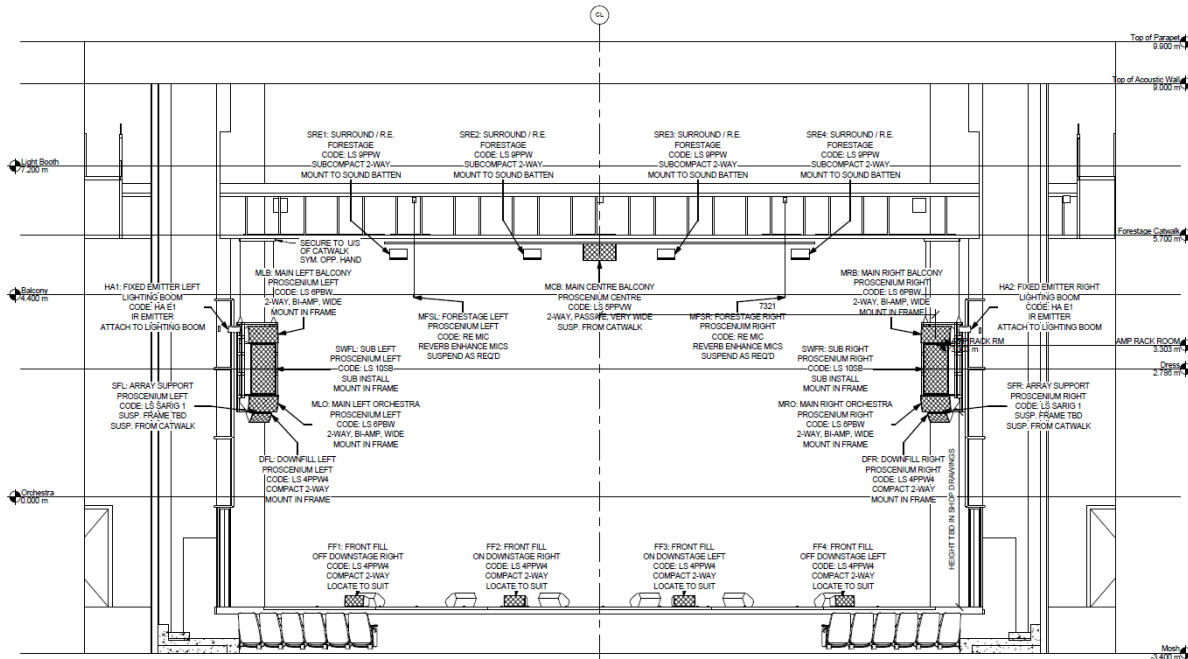

AKG	4 Units -DSR800 8 Channels
Body Pack	8- Units - DPT800
Lav Mic	2 Units C417 L
Handheld	4 Units - DHT 800
Head worn	12 - C 111LP
Head worn Mc	HSP 4, 4 Units
Wireless in Ear Monitor Kits	
Sennheiser	EW 300 IEM G2 Transmitters, 4 Units
	*Includes body pack and ear phones
	*All unit ear buds are black in colour

Microphones	
Shure 58	6 Units
Shure Beta 58 A	3 Unit
AKG 535 Condenser	5 Units
Shure SM81 Condenser	6 Units
CAD E : 100 Conneaut Audio Devices Equitek	2 Units
AKG C 480 Condenser	2 Units
Sennheiser 904e	4 Units
Sennheiser MD 421	2 Units
Shure Beta SM 57	1 Unit
Shure SM 57	7 Units
AKG D112	1 Unit
AKG C 1000 S	2 Units
Crown 200 PCC	4 Units
Countryman Active Direct Boxes	6 Units
Cable factory Di:Pro:P1. Passive Direct Box	8 Units
Sennheiser Shotgun Mics Permanently Mounted For Program And I.R. Feeds	2 Units

Clear:Com	
2 HME DX410 Base Stations	Located in SL wing, Located in FOH
Belt pack with headsets	6 Units

Additional Audio Equipment	
32 channel transformer isolated 3 way splitter snake	1 Unit
50' 8 channel x 4 return sub snake	1 Units
50' 12 channel sub snake	1 Unit
Tall Mic Stands	24 Units
Short Mic Stands	12 Units
Music Stands	70 Units
Music Stand Lights	8 Units
Guitar Stands	6 Units
Various adaptors and ground lifts	

NOTES

- FOH console / booth is located on the main floor at the back of the theatre just off centre. It is under the balcony. **The equipment may not be removed from this location.**
- All console rear panel connections, outboard gear connections, tie lines, amplifier inputs etc. are accessible via a patch field located in the FOH booth.
- There are 24 mic lines and 16 tie lines located in wall boxes on stage and terminate in the patch field in the FOH booth.

THEATRE LIGHTING EQUIPMENT INVENTORY

Control	
ETC Gio	*with 2 iPhones equipped with iRFR App control
ETC Nomads (2)	1 x 512 outputs, 1 x 6144 outputs
Dimmers/ Relays	
Thru-Power Card	38 (76 Addresses)
Dimmer Card	14 (28 Addresses)
Relay Card	69 (138 Addresses)

Lighting Equipment Inventory, Instruments (Subject to change during season)		
ETC Source 4 Lekos	750 watts	90 Units
ETC Source 4 Lens Barrels	10 Degrees	2 Units
	19 Degrees	43 Units
	26 Degrees	68 Units
	36 Degrees	48 Units
	50 Degrees	62 Units
Fresnels, ColourTran and Strand	6 Inch 1k	11 Units
	8 Inch 2k	10 Units
Single cell Altman Cyc Lights	20"x20"	8 Units
ETC Pars	6" 750 watt	15 Units
	Lens options: Very Narrow, Narrow, Medium, Wide	
Followspot	19 Degree Leko on pivot	
Chroma Q Scrollers	10 Units	
	Rosco Gel String – 3208, 3408, 05, 312, 21, 23, 26, 31, 336, 54, 355, 65, 370, 79, 389, 2004	
VL 1000	9 Units, Tungsten with shutters, no iris unit	
VL 2000	3 Units, 575 watt HMI	
Color Source Spots	54 Units	
Source 4 Lustr	45 Units	
Vivid R	60 Units	
Fuze Pars	15 Units	
Chauvet Colorado	15 Units	
Wooden floor plates	21 Units	

Side booms	10 Units 6'x8' and 4'x10'	
Barndoors	6"	17 units '8 way' barndoors
	6"	10 units '4 way' barndoor with gel extender
	8"	10 units '8 way' barndoors
Source 4 Drop In Iris Kits	10 Units	
Source 4 Size .A Gobo Holder	25 Units	
Source 4 Size .B Gobo Holder	25 Units	
Source 4. Single glass gobo holder	11 Units	
Source 4. Double glass gobo holder	8 Units	
Colortran Gobo Holder	6 Units	

NOTES

- We have a reasonable stock of Rosco gel filters, however artists are asked to bring their own colour.
- Please contact the Technical Director if you will change the house plot.
- Some lighting instruments may not be available due to servicing.

PROJECTORS			
1 Barco DP2K-10s	9000 Lumens	2048 x 1080 Pixel Native Resolution	DC2K Lens 1.34-1.90
Epson I510U	5000 Lumen (White) 5000 Lumen (Colour)	1920 x 1200 Pixel Native Resolution	Manuel Zoom 1.5 – 1.7

STAGE PLOT

EVENT:

DATE :

SYMBOLS:



VOCAL MICROPHONES
List Type/ Style



INSTRUMENT MICROPHONE
List Type/ Style

DI

DIRECT INPUT

AMP

MUSIC AMPLIFIER



MUSIC STAND

T

TABLE



MONITOR WEDGE



DRUM KIT RISER

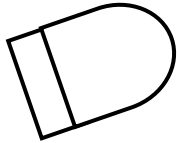

PIANO



CHAIR



STOOL

Centre Line

