

THEATRE TECHNICAL SPECIFICATIONS

The Yukon Arts Centre Theatre opened in 1992, located next to Yukon College in Whitehorse, Yukon. It is a wheelchair-accessible, climate controlled Class "A" facility featuring a Public Art Gallery, rehearsal hall, and shop.	
THEATRE	
Seating:	Main Floor: 306. Balcony: 112. Wheelchairs: 10 Total: 428 (10 seats are always reserved for the volunteer ushers)
Stage description:	Elevated proscenium with removable apron, orchestra pit and fly loft. No traps unless custom fitted within apron sections.
Stage Floor:	Black 1/4" marmoleum on 1/8" cork on 3/4" plywood NOTHING MAY BE SCREWED OR FASTENED TO THE STAGE FLOOR
Stage Width:	47' / 14.33m
Stage Depth:	37' / 11.28m
Proscenium opening:	Width: 48' / 14.63m / Height: 24.5' / 7.47m
Clear height to P.A. cluster:	22' / 6.71m
Plaster line to U.S. wall:	32' / 9.75m
Plaster line to D.S. apron edge:	13' / 3.96m
Centre line to S.R. fly rail:	41.5' / 12.65m
Centre line to S.L. wall:	46' / 14.02m
DRESSING ROOMS and GREEN ROOM	
#1 & #2 – 7' X 7' w/ shower, washroom, sink, prep and dressing area, Clear-com communication. Dressing Room #1 is fully wheelchair accessible.	
#3 & #4 : 10' X 23' w/ showers, washrooms, sinks, prep and dressing tables Clear-com communication.	
Green Room: 21' X 23' w/ fridge, range, microwave, sink, telephone, Clear-com communication.	
FLY INFORMATION	
Total Line-sets:	36
Occupied Line-sets:	Please Request Current List
Loading Capacity:	1700lbs / 771 kg
Length of Pipes:	60ft. / 18.29m
Diameter of Pipes:	1.5" / 3.81cm. Schedule 40
Grid height:	62.5' / 19.05m
Operation : 2 sets of locking rails:	S.R. at stage level and S.R. fly floor (26')
STAGE DRAPERY	
1 Main Valance (Navy Blue) : Line-sets 1	
1 Main Curtain (Navy Blue) drawn or flown : Line-sets 2	
6 sets of black 28' X 10' / 8.53m x 3.04 legs 4 sets of black 32' X 6' / 8.53m x 1.82m legs 1 Black Scrim 28' x 60' / 8.53 X 18.29m	
2 traveller tracks with blacks, 1.5 fullness, split at Centre: Line-sets 24 and 39. Operated S.R.	
1 white 28' X 60' / 8.53 X 18.29m cyclorama	

1 white 28' X 60' / 8.53 X 18.29m cyclorama

STAGE PLANS: PLEASE CONTACT THE TECHNICAL DIRECTOR

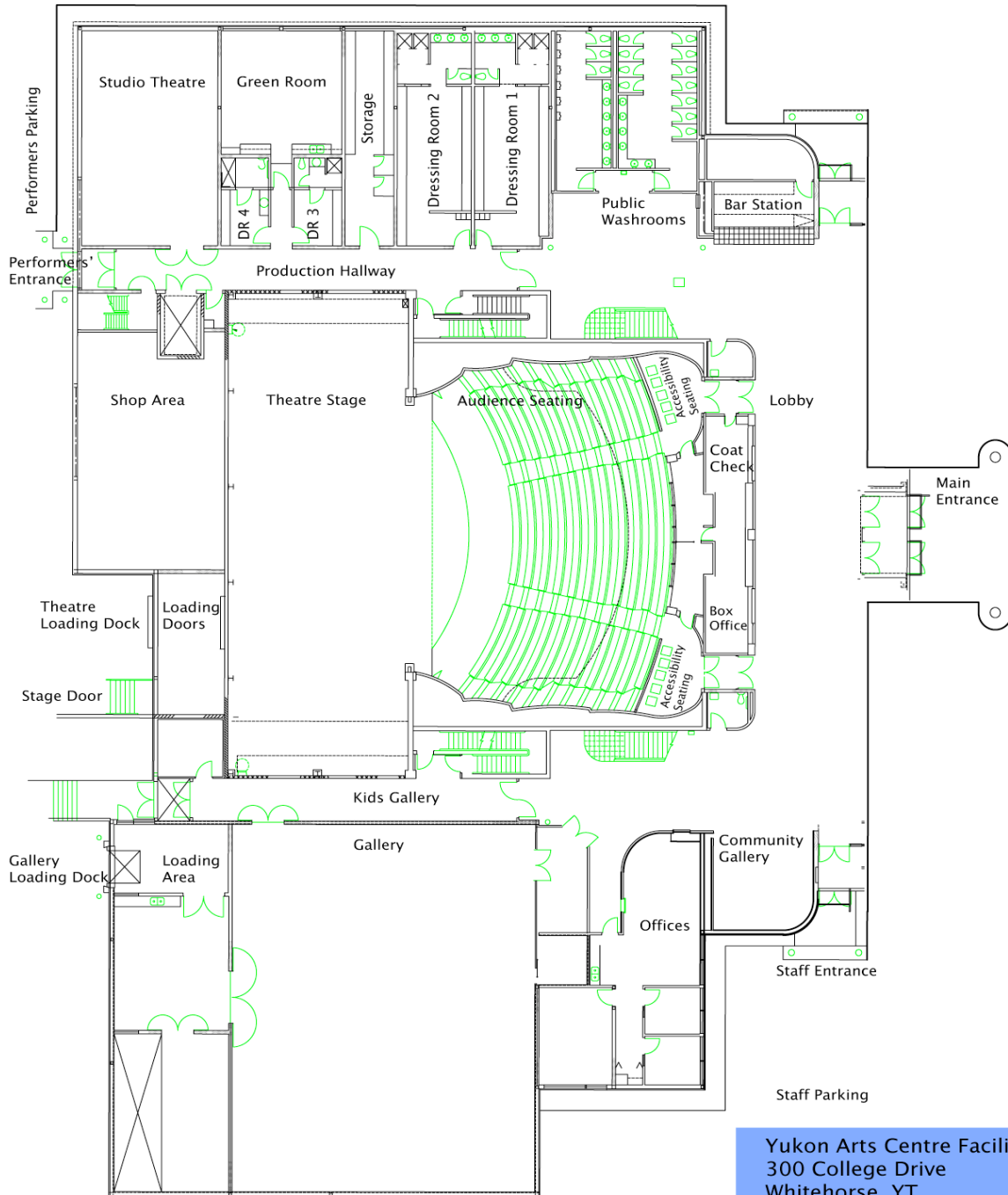

Yukon Arts Centre Facility
300 College Drive
Whitehorse, YT
www.yukonartscentre.ca
Image is not to scale

APPENDIX B:

THEATRE AUDIO INVENTORY

Audio Inventory Front of House	
FOH Console	SOUNDCRAFT VI6 Digital Mixer
	64 mono balanced inputs into 35 outputs
	Mono inputs linked to create stereo inputs
Busses:	32 Grp/Aux/Matrix plus Main LCR Mix and LR Solo Bus
Stage Box:	64 XLR inputs and 32 XLR outputs
Front of House Speakers, JBL System	
Fill Speakers	6 JBL AC18/95
Centre	1 JBL AM5212/26
Main Speakers	4 JBL AM7212/95
	2 JBL ASB6128
Reverb Enhancement Speakers	12 JBL AC16
Surround Speakers	
	14 JBL Control HST-WH
	2 JBL CONTROL 28T-60-WH
	4 JBL AC16
Monitor Mixer/Alternative Front of House Mixer	
Monitor Console	Soundcraft VI1 Digital Mixer
	32 Mono Balanced Inputs
	2 Stereo inputs
	L,R and M outputs
	24 Auxiliaries
Monitor Mode	Can provide up to 16 mixes
Monitor Speakers	
800w 12" Two-way	16 JBL STX812M
1000w 18" subwoofer	4 JBL STX818S
Playback and Recording	
	1xDenon DN C635 CD/MP3 Player
	1xDenon DN – D6000 DUAL CD/MP3 Player with full wired remote

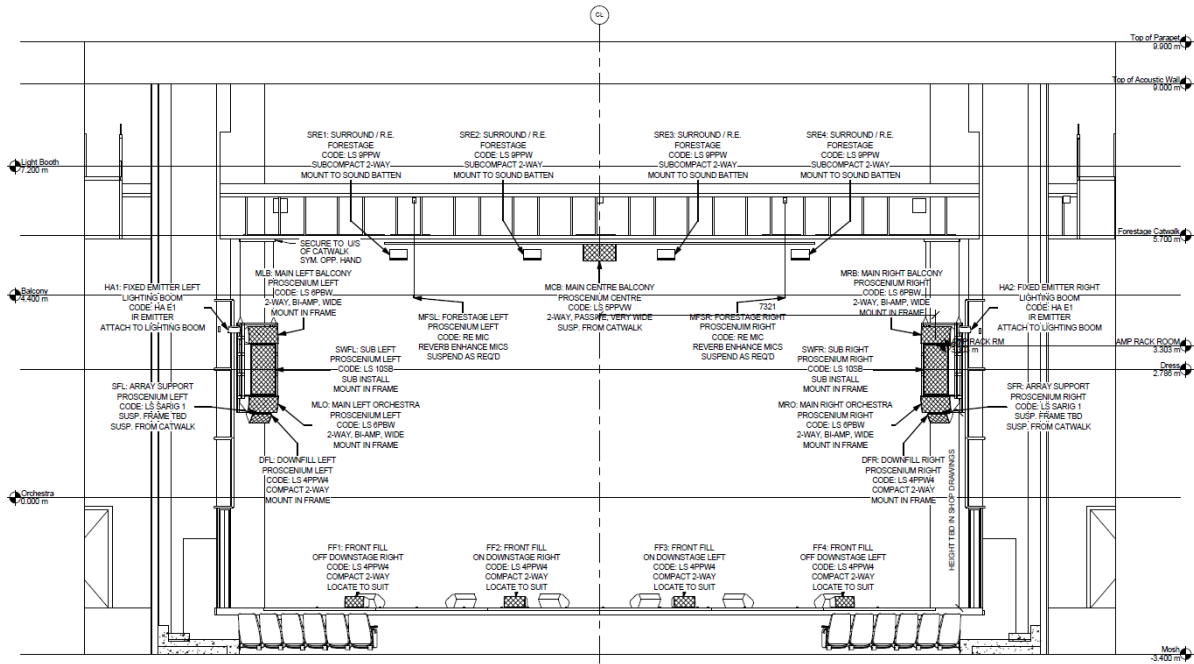

Wireless Microphones/Wireless Receivers/Microphone Transmitter	
AKG	4 Units -DSR800 8 Channels
Body Pack	6- Units - DPT800
Lav Mic	C417 L
Handheld	4 Units - DHT 800
Head worn	6 - C 111LP
Head worn Mc	HSP 4, 4 Units
Wireless in Ear Monitor Kits	
Sennheiser	EW 300 IEM G2 Transmitters, 4 Units
	*Includes body pack and ear phones
	*All unit ear buds are black in colour

Microphones	
Shure 58	10 Units
Shure Beta 58 A	1 Unit
Shure Beta 58	2 Units
AKG 535 Condenser	5 Units
Shure SM81 Condenser	6 Units

CAD E : 100 Conneaut Audio Devices Equitek	2 Units
AKG C 480 Condenser	2 Units
Sennheiser 904e	4 Units
Sennheiser MD 421	2 Units
Shure Beta SM 57	1 Unit
Shure SM 57	7 Units
AKG D112	1 Unit
AKG C 1000 S	2 Units
Crown 200 PCC	4 Units
Countryman Active Direct Boxes	6 Units
Cablefactory Di:Pro:P1. Passive Direct Box	8 Units
Sennheiser Shotgun Mics Permanently Mounted For Program And I.R. Feeds	2 Units

Clear:Com	
4 channel Master station	Located in lighting booth, 1 Unit
4 channel Master station	Located in SL wing, 1 Unit
2 channel RM201 station	Located in sound booth, 1 Unit
2 channel RM201 station	Located in lighting booth, 1 Unit
Belt pack with headsets	6 Units
	*Green room and each dressing room is equipped with 1 KB:112 speaker station

Additional Audio Equipment	
32 channel transformer isolated 3 way splitter snake	1 Unit
50' 8 channel x 4 return sub snake	1 Units
50' 12 channel sub snake	1 Unit
Tall Mic Stands	24 Units
Short Mic Stands	12 Units
Music Stands	50 Units
Music Stand Lights	12 Units

Guitar Stands	6 Units
Various adaptors and ground lifts	

NOTES

- **FOH console / booth is located on the main floor at the back of the theatre just off centre. It is under the balcony. The equipment may not be removed from this location.**
- **All console rear panel connections, outboard gear connections, tie lines, amplifier inputs etc. are accessible via a patch field located in the FOH booth.**
- **There are 24 mic lines and 16 tie lines located in wall boxes on stage and terminate in the patch field in the FOH booth.**

THEATRE LIGHTING EQUIPMENT INVENTORY

Lighting Equipment Inventory, Control	
ETC Gio	*Ipad and Iphone with remote focus App
ETC Insight 3 with 2 LCD Monitors	*Wireless focus remote *Note: we do not supply a designers remote
Lighting Equipment Inventory, Dimmers	
Colortran ENR Dimmers 2.4 K	284 Units
Colortran ENR Dimmers 6 K	2 Units

Lighting Equipment Inventory, Instruments (Subject to change during season)		
ETC Source 4 Lekos	740 watts	110 Units
	575 watts	16 Units
ETC Source 4 Lens Barrels	10 Degrees	2 Units
	19 Degrees	45 Units
	26 Degrees	68 Units
	36 Degrees	59 Units
	50 Degrees	77 Units
Fresnels, ColourTran and Strand	6 Inch 1k	14 Units
	8 Inch 2k	10 Units
Single cell Altman Cyc Lights	20"x20"	8 Units
ETC Pars	6" 750 watt	31 Units
	Lens options: Very Narrow, Narrow, Medium, Wide	
Kimberly Par 64	MFLK 1K	20 Units
Followspot	None	
Chroma Q Scrollers	10 Units	
	Rosco Gel String – 3208, 3408, 05, 312, 21, 23, 26, 31, 336, 54, 355, 65, 370, 79, 389, 2004	
VL 1000	10 Units, Tungsten with shutters, no iris unit	
VL 2000	4 Units, 575 watt HMI	
	*Separate rental and operator rates apply for this equipment	

	*Please contact the Technical Director for more information	
Color Source Spots	62 Units	
Source 4 Lustr	45 Units	
Vivid R	60 Units	
Fuze Pars	15 Units	
Chauvet Colorado	15 Units	
Wooden floor plates	21 Units	
Side booms	10 Units 6'x8' and 4'x10'	
Barndoors	6"	17 units '8 way' barndoors
	6"	10 units '4 way' barndoor with gel extender
	8"	10 units '8 way' barndoors
Source 4 Drop In Iris Kits	10 Units	
Source 4 Size .A Gobo Holder	25 Units	
Source 4 Size .B Gobo Holder	25 Units	
Source 4. Single glass gobo holder	11 Units	
Source 4. Double glass gobo holder	8 Units	
Colortran Gobo Holder	6 Units	

NOTES

- We have a reasonable stock of Rosco gel filters, however artists are asked to bring their own colour.
- Please contact the Technical Director if you will change the house plot.
- Some lighting instruments may not be available due to servicing.

Projectors,		
Barco 10s	Native resolution	2,048 x 1,080 pixels
9000 Lumens	Len	0.69" DC2K Lens 1.34-1.90
Sanyo PDG-DHT100L	Video Modes:	720p, 1080i, 1080p/60 1080p/24, 1080p/25, 1080p/30 1080p/50, 575i, 575p 480p, 480i
6,500 Lumens	Lens	Standard Zoom Lens f38.5-60.0mm F2.0-2.6

Aspect Ratio 16:9		
Sanyo PLC-XF60	Video Modes:	720p, 1080i, 1035i 575i, 480p, 480i
6,500 Lumens	Lens	Short throw zoom lens
Aspect Ratio 4:3		

STAGE PLOT

EVENT:

DATE :

SYMBOLS:



VOCAL MICROPHONES
List Type/ Style



INSTRUMENT MICROPHONE
List Type/ Style

DI

DIRECT INPUT

AMP

MUSIC AMPLIFIER



MUSIC STAND

T

TABLE



MONITOR WEDGE



DRUM KIT RISER

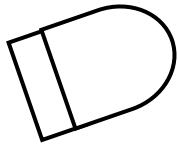

PIANO



CHAIR



STOOL

Centre Line

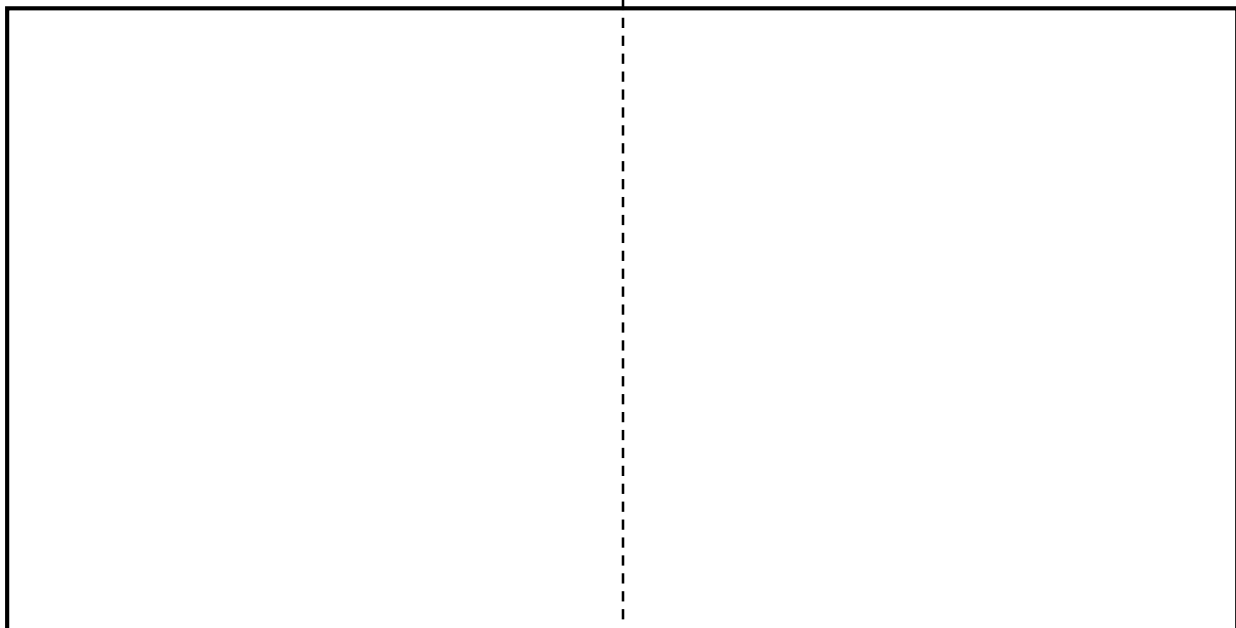

AUDIENCE

BOOTH